

BUILD UP Skills exchange meeting - Session 2

Supporting the digital transformation of the building sector



Why and How construction site workers should use BIM models ?

BIMplement objective :

Get site workers to use BIM models

- BIM process mainly used by the project managers' team
... but
- **Site managers and site workers never appear in the BIM process**
- Why should they use BIM models ?
What for ?



What tool for site workers to use BIM models

- Manipulate **freeware BIM Viewers**
 - discover the project in 3D (instead of just 2D plans)
 - Use **basic tools** that will be needed for the planned BIM process
- 2 days training

Why use BIM models on site (1)

- Understand the **project as a whole**
- Better answer to a call for bid
- **Check interfaces** between batches

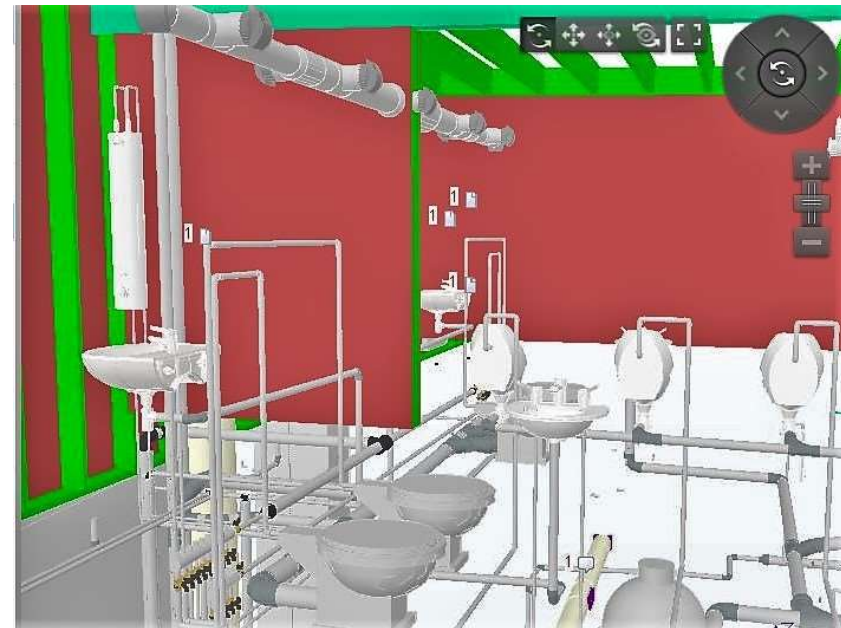
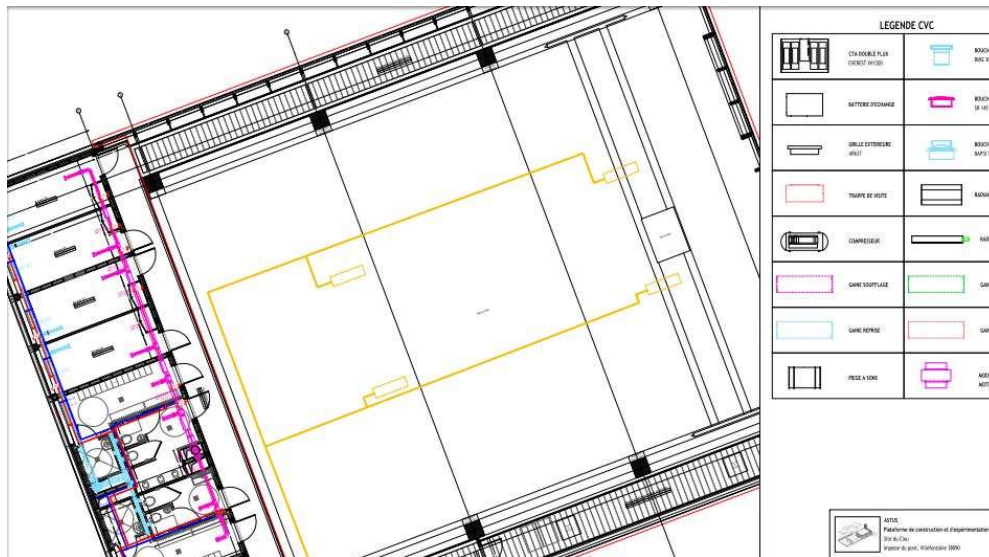

Why use BIM models on site (2)

- Use the viewers communication tools
 - Improve cross-trade and cross level **collaboration** during execution phase
 - Exchange on a problem with a screen copy of the BIM model

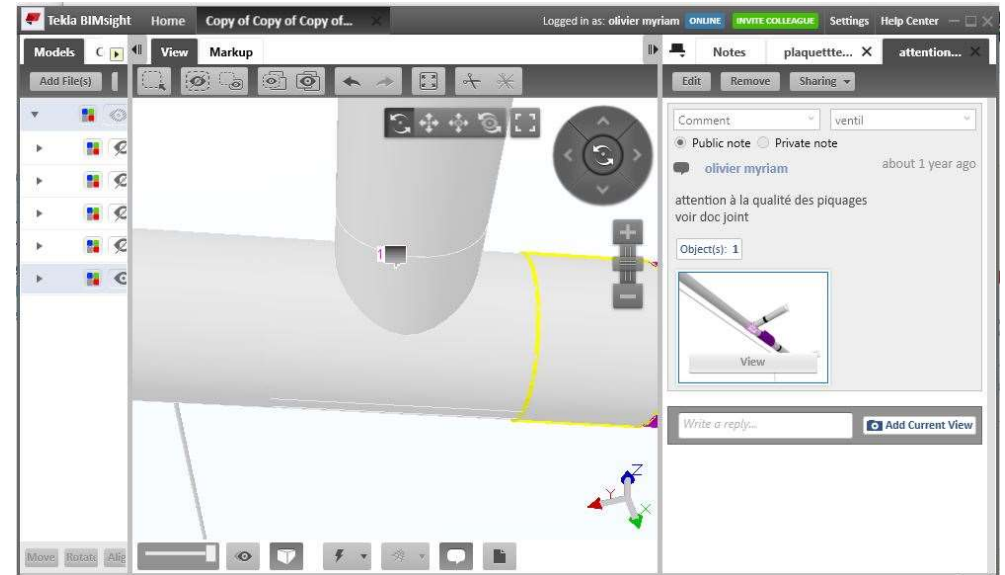

Why use BIM models on site (3)

- **Enrich the BIM models with updated data and technical documents**
 - Link installation guide of actual product
 - Report on changes
 - Participate in the **digital as-built model**

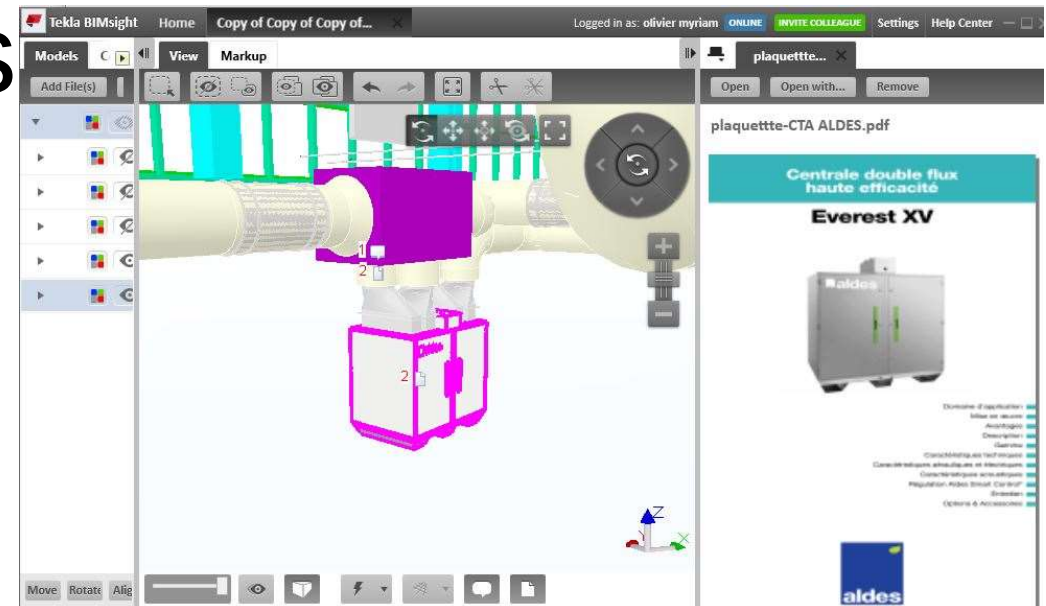

How to have site workers use BIM models

- Enlarge the BIM process to the execution phase
- Set the roles and responsibilities of each stakeholder
- Clients have the power to enforce the use of BIM during the execution phase



Conclusions

- **Building companies' site workers can and must be involved in the BIM process**
- better implementation & nZEB quality
- **Develop training for trainers**
- Answer the site workers needs via the BIM model and enlarged BIM process



Thanks for your attention

www.bimplement-project.eu



This project has received funding from the European Union's h2020 framework programme for research and innovation under grant agreement no 745510

The information in this publication does not necessarily represent the view of the European Commission.

*© BIMplement
All rights reserved. Any duplication or use of objects such as diagrams in other electronic or printed publications is not permitted without the author's agreement.*

